

# HOOK LABEL HOLDERS HOOK AND LABEL HOLDER CONCEPTS



## Hook Terminology

**Display vs. Scan:** Display hooks can only display product and are without any provision for labels or signs. Scanning hooks have mounts for label and sign holders allowing the posting of product and promotional information. There are a wide variety of different label holder systems for Scan Hooks, each with its own benefits. Beyond basic Display and Scan Hooks are a host of specialty fixtures including J-hooks, Utility and Broom Hooks, Pin-up Hooks, Strip Merchandisers and more for wall and shelf edge product display.

**Hook Display Surfaces:** Vertical display surfaces for hooks include pegboard, slatwall and slatwire, end cap and power wing, wire grid, bar and cross bar, corrugated (cardboard), perforated metal, plastic panel, Uniweb, gondola uprights, pallet rack face, and C-channel

and other shelf edges. Some hooks are multipurpose and can attach to more than one surface. Others are available in separate styles for each surface, or can be modified to mount to any surface you choose. Our catalog is organized by display surface, while the potential uses of multipurpose hooks is specifically noted throughout.

**Straight Entry:** Fixture solutions range from simple to sophisticated. For some users the simplest, lowest cost solution is correct. Merchandising is low key and cost is held down with inexpensive fixtures. Other retailers maximize sales through savvy merchandising, refreshing displays, seasonal selling, and tight, no-wasted-space planograms. For sophisticated retailing, straight entry hooks, articulated plain-paper label holders, built-in sign clips and other strategies boost sales more than the increase in fixture cost.

Straight entry hooks, for example, mount directly to the board without the need for extra clearance above to insert the hook. Straight entry hooks therefore maximize product density, provide easy mounting and relocation of stocked hooks in tight places, under shelves or in fully loaded displays, and speed re-merchandising and display changeover. Straight entry hooks can be of two-piece, one-piece, or two-piece pre-assembled design, depending upon your need. Similarly plain paper label holders and built-in sign clips lower labor and material costs while allowing rapid change of promotions and response to competition and marketplace desires. When purchasing fixtures you should weigh cost against merchandising features and increased sales. Trion is always willing to provide fixture samples. Under some circumstances store trials are warranted and recommended.

## Metric Conversion FORMULAS

### Inches to Millimeters

$$\text{Inches} \times 25.40 = \text{Millimeters}$$

Example:

$$3 \text{ inches} \times 25.40 = 76.20 \text{ millimeters}$$

### Millimeters to Inches

$$\text{Millimeters} \times 0.03937 = \text{Inches}$$

Example:

$$7 \text{ millimeters} \times 0.03937 = 0.2756 \text{ inches}$$

## Wire Hook Dimensions

The hook dimensions referred to throughout our catalog are indicated below.

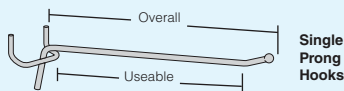

Single Prong Hooks

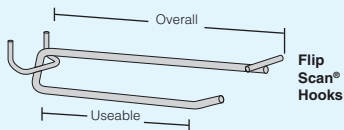

Flip Scan Hooks

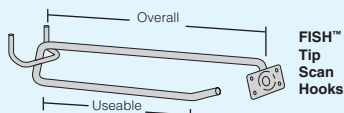

FISH Tip Scan Hooks

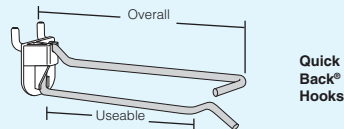

Quick Back Hooks

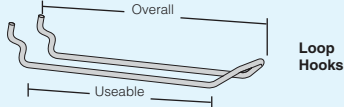

Loop Hooks

Trion and Flip Scan are registered trademarks of Trion Industries, Inc. FISH Tip is a trademark of Trion Industries, Inc.

## Actual Wire Diameter

| Wire Gauge | Diameter Inches | Diameter Millimeters | Drawings to Scale |
|------------|-----------------|----------------------|-------------------|
| 11 ga.     | .120            | 3.06                 |                   |
| 9 ga.      | .148            | 3.77                 |                   |
| 7 ga.      | .177            | 4.49                 |                   |
| 3/16"      | .187            | 4.76                 |                   |
| 4 3/4 ga.  | .212            | 5.38                 |                   |
| 4 ga.      | .225            | 5.72                 |                   |
| 1/4"       | .250            | 6.35                 |                   |
| 5/16"      | .312            | 7.92                 |                   |
| 3/8"       | .375            | 9.52                 |                   |

# HOOK LABEL HOLDERS HOOK AND LABEL HOLDER CONCEPTS

## Shelf Profiles *Manufacturer specifications may change without notice.*

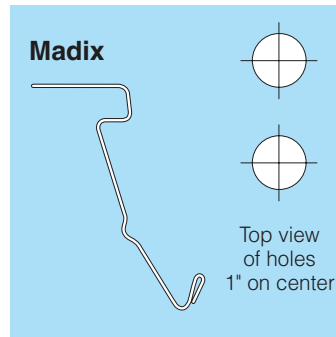
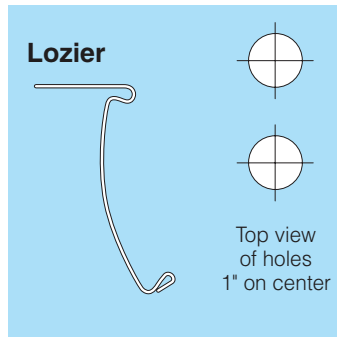
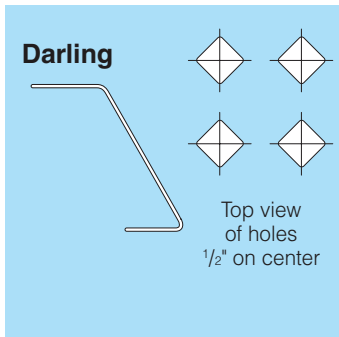
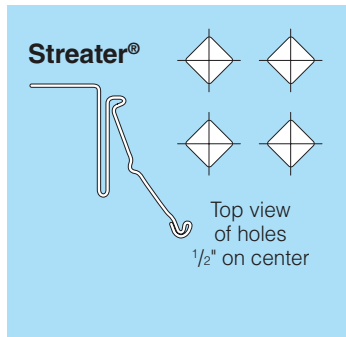

| Pack Code              | Price per 100 Hooks |        |        |        |        |        |        |
|------------------------|---------------------|--------|--------|--------|--------|--------|--------|
|                        | 2-4                 | 5-14   | 15-24  | 25-40  | 41-60  | 61-80  | 81-100 |
| <b>Bagging Charges</b> |                     |        |        |        |        |        |        |
| A                      | \$1.52              | \$1.19 | \$1.09 | \$0.96 | \$0.88 | \$0.75 | \$0.66 |
| B                      | 1.59                | 1.29   | 1.16   | 1.06   | 0.95   | 0.85   | 0.72   |
| C                      | 2.10                | 1.77   | 1.60   | 1.48   | 1.38   | 1.26   | 1.13   |
| D                      | 2.26                | 1.91   | 1.74   | 1.58   | 1.44   | 1.33   | 1.22   |
| E                      | 2.33                | 1.98   | 1.80   | 1.66   | 1.54   | 1.40   | 1.29   |
| F                      | 2.40                | 2.03   | 1.84   | 1.71   | 1.61   | 1.49   | 1.36   |
| G                      | 2.48                | 2.11   | 1.93   | 1.77   | 1.65   | 1.53   | 1.39   |
| H                      | 2.53                | 2.17   | 1.98   | 1.80   | 1.66   | 1.56   | 1.43   |
| I                      | 2.57                | 2.21   | 2.00   | 1.82   | 1.69   | 1.58   | 1.51   |
| J                      | 2.64                | 2.27   | 2.06   | 1.92   | 1.79   | 1.66   | 1.54   |
| K                      | 2.75                | 2.37   | 2.16   | 2.00   | 1.80   | 1.68   | 1.55   |
| L                      | 2.80                | 2.41   | 2.20   | 2.03   | 1.91   | 1.78   | 1.65   |
| M                      | 2.85                | 2.46   | 2.24   | 2.06   | 1.94   | 1.81   | 1.69   |
| N                      | 3.05                | 2.64   | 2.40   | 2.25   | 2.06   | 1.94   | 1.80   |
| O                      | 3.10                | 2.69   | 2.45   | 2.26   | 2.07   | 1.95   | 1.81   |
| P                      | 3.28                | 2.84   | 2.60   | 2.41   | 2.18   | 2.03   | 1.87   |
| Q                      | 3.31                | 2.87   | 2.62   | 2.43   | 2.20   | 2.05   | 1.91   |
| R                      | 3.36                | 2.92   | 2.66   | 2.46   | 2.23   | 2.07   | 1.92   |
| S                      | 3.47                | 3.00   | 2.72   | 2.55   | 2.31   | 2.14   | 1.98   |
| T                      | 3.55                | 3.08   | 2.81   | 2.62   | 2.37   | 2.21   | 2.04   |
| U                      | 3.64                | 3.16   | 2.87   | 2.69   | 2.44   | 2.27   | 2.10   |
| V                      | 3.74                | 3.25   | 2.94   | 2.77   | 2.49   | 2.33   | 2.16   |
| W                      | 3.83                | 3.32   | 3.03   | 2.84   | 2.57   | 2.40   | 2.22   |
| X                      | 3.92                | 3.41   | 3.09   | 2.91   | 2.63   | 2.46   | 2.27   |
| Y                      | 4.01                | 3.49   | 3.16   | 2.98   | 2.70   | 2.53   | 2.35   |
| Z                      | 4.11                | 3.56   | 3.25   | 3.06   | 2.76   | 2.60   | 2.40   |

All quantities and sizes cannot physically be bagged.

## Bagging Charges

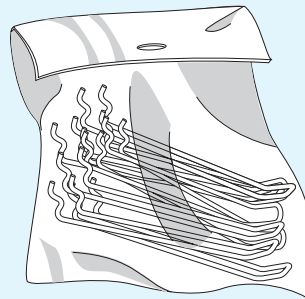

Bagging charges shown are per 100 hooks. This charge is to be added to the appropriate hook price to determine your total cost. **An order must be a minimum of 1,000 pieces per item for custom bagging.**

**Important:** If hook price shown is per 1,000 simply multiply the bagging charge by 10 to determine total charge per 1,000 for bagging.

# HOOK LABEL HOLDERS HOOK AND LABEL HOLDER CONCEPTS



## Flip Scan® Label-Holder Mount

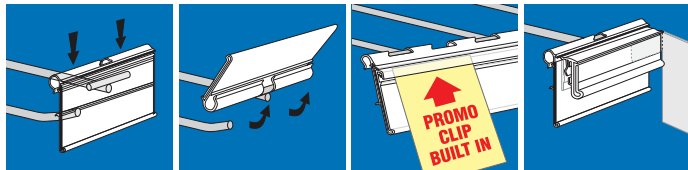

Accepts Flip Scan Label Holders.

Flip Action for easy access.

Available to mount across rows of hooks.

Info Grip™ built-in promo clip optional.

Accepts CST Flag Holder for promos.

### Flip Scan® Features

Inexpensive Flip Scan® label holders mount to any size or gauge hook, eliminating the need for stocking multiple label holders. Label holder is articulated, swings up out of the way as product vends, then automatically falls back into position.

Inexpensive plain paper labels drop right into place protected by a long life, UV-protected window. Saves labor and material costs over expensive adhesive label systems.

“No window” adhesive label holder version available while transitioning to plain paper labels or when use of pressure sensitive labels remains desirable.

Flip Scan label holders attach to traditional FISH™ Tip mounts preserving earlier investments in hook hardware as you transition to newer technology. Compatible with Clear Scan® storewide and shelf edge label holder system for c-channel; flat faced shelves; wire basket/fencing; solid, wood, and glass shelves; freezer/cooler environments, and scan hook.

## FISH™ Tip Label-Holder Mount

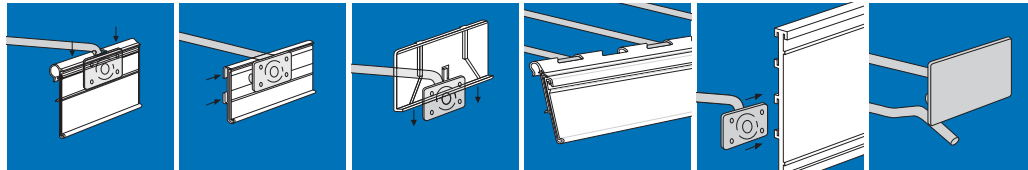

Accepts Flip Scan Label Holders.

Accepts Extruded Label Holders.

Accepts Molded Label Holders.

Label Holders available to mount across rows of hooks.

Sign Holders available to mount across rows of hooks.

Optional Metal Plate Label Holder can replace FISH™ Tip.

### FISH™ Tip Features

FISH™ Tip label holder types mount to any size or gauge hook, eliminating the need for stocking multiple label holders.

Accepts Flip Scan® label holders for drop-in plain-paper and adhesive labels, extruded label holders for drop-in, slide-in, and adhesive labels; and molded label holders for slide-in or adhesive labels.

Compatible with all FISH™ Tip equipped hardware elements including basket tags, wall tags, shovel bases, etc.

# HOOK LABEL HOLDERS

## HOOK AND LABEL HOLDER CONCEPTS



### Right Angle Label-Holder Mount

#### Right Angle Features

Simple, inexpensive design.

Requires different size label holders to mount to different gauge hooks.

Accepts drop-in and snap-close label holders for plain-paper labels.

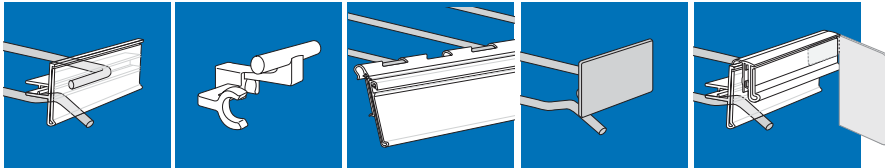

Accepts Right Angle Holders (No flip).

Accepts Flip Scan® Label Adaptor.

Label Holders available to mount across rows of hooks.

Optional Metal Plate Label Holder can be welded to right-angle arm.

Accepts CPT Flag Holder for promos.

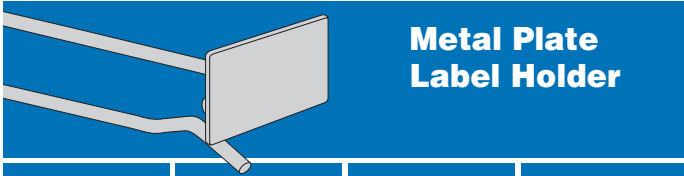

### Metal Plate Label Holder

#### Metal Plate Features

For traditional adhesive labels.

Heavy duty construction.

Alternate metal plate sizes include:

| Metal Plates    | H x W   |
|-----------------|---|
| Metal Plate #3  | 3 <sup>1</sup> / <sub>32</sub> " x 1 <sup>5</sup> / <sub>16</sub> " |
| Metal Plate #4  | 1 <sup>1</sup> / <sub>4</sub> " x 2 <sup>1</sup> / <sub>8</sub> "   |
| *Metal Plate #5 | 1 <sup>3</sup> / <sub>8</sub> " x 2 <sup>1</sup> / <sub>8</sub> "   |
| Metal Plate #6  | 1 <sup>1</sup> / <sub>4</sub> " x 3 <sup>3</sup> / <sub>8</sub> "   |
| Metal Plate #7  | 1 <sup>1</sup> / <sub>4</sub> " x 1 <sup>5</sup> / <sub>8</sub> "   |
| Metal Plate #8  | 1 <sup>1</sup> / <sub>4</sub> " x 1 <sup>7</sup> / <sub>8</sub> "   |
| Metal Plate #9  | 1 <sup>1</sup> / <sub>4</sub> " x 3"                                |
| Metal Plate #10 | 2" x 1 <sup>1</sup> / <sub>8</sub> "                                |
| Metal Plate #12 | 1 <sup>3</sup> / <sub>8</sub> " x 1 <sup>6</sup> / <sub>16</sub> "  |
| Metal Plate #17 | 1 <sup>1</sup> / <sub>4</sub> " x 2"                                |
| Metal Plate #18 | 1 <sup>1</sup> / <sub>4</sub> " x 6"                                |

\*Metal Plate #5 is the standard plate used on metal plate scanning hooks shown in the catalog. Other sizes are available. Call for information. Minimums may be required.

Note: All of the Metal Plate Scanning Hooks shown on these pages can also have our regular FISH™ Tip welded to the front to accept our plastic label holders or signs as shown on pages 16-20.

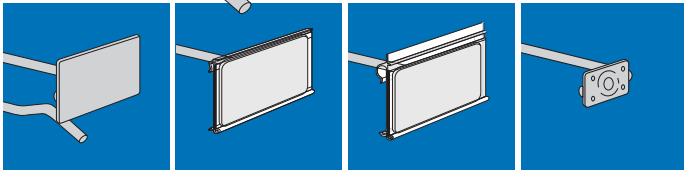

Metal Plate #5 Standard, others available. For adhesive labels.

Accepts MCLH Label Holder for drop in plain-paper labels.

Accepts MCLH Label Holder for drop in plain-paper labels.

Optional FISH™ Tip Label-Holder Mount can replace Metal Plate.



### Peg Hook Overlay Label Holder

#### Peg Hook Overlay Features

Converts All Wire Display Hooks to Scan Hooks

Mounts on pegboard, slatwall, corrugated and perforated metal All Wire Hooks.

Fits various hook lengths.

Flat front design allows for secure placement of adhesive or drop-in plain paper labels.

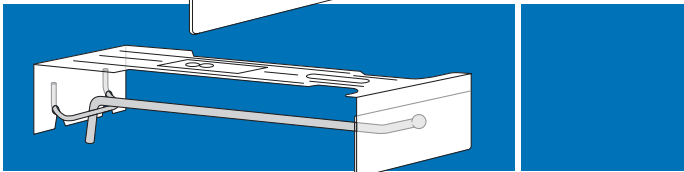

Mounts on a variety of All Wire Display Hooks

Styles that accept drop-in plain paper or adhesive labels